

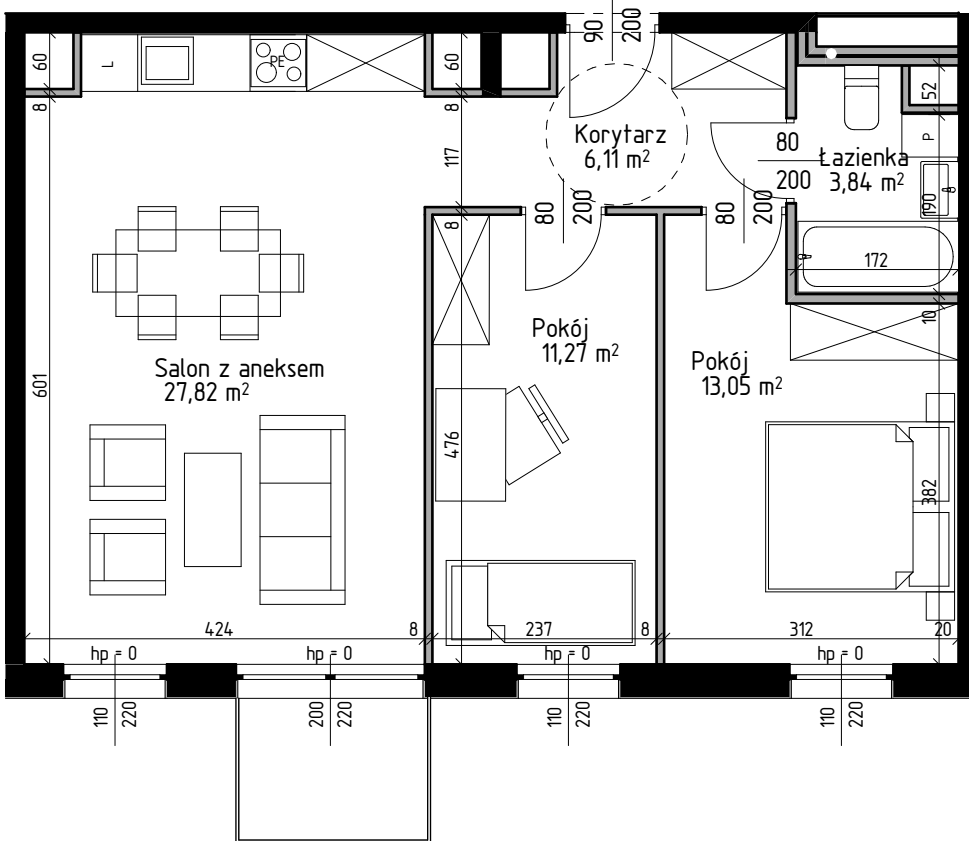



0 1 2



MIESZKANIE 3P+AK	NR B/5/55
Korytarz	6,11
Łazienka	3,84
Pokój	13,05
Pokój	11,27
Salon z aneksem	27,82
	62,09 m ²

ŚCIANY DZIAŁOWE 
 ŚCIANY NOŚNE 

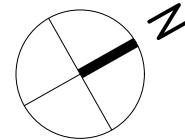

PIĘTRO +5

